



Shillingford Close

£1,950 Per Month

Cosway Estates are pleased to offer for rent this spacious modern well-presented two bedroom/two bathroom flat located in the highly sought after Ladbury Square Development in Mill Hill East.

This property comprises of a spacious open-plan kitchen, dining, and living area, perfect for both everyday living and entertaining. The master double bedroom benefits from having a modern en-suite shower room, while the second bedroom is also a generously sized double, served by a stylish family bathroom. This property comes with an allocated parking space. Just a short walk to Waitrose, the Virgin Active gym and to Mill Hill East Tube Station (Northern Line). AVAILABLE MARCH 2026. Viewings highly advised.

Viewing

Please contact our Mill Hill Office on 02089590011 if you wish to arrange a viewing appointment for this property or require further information.



2



2

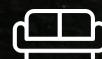

1



B

Floor Plan

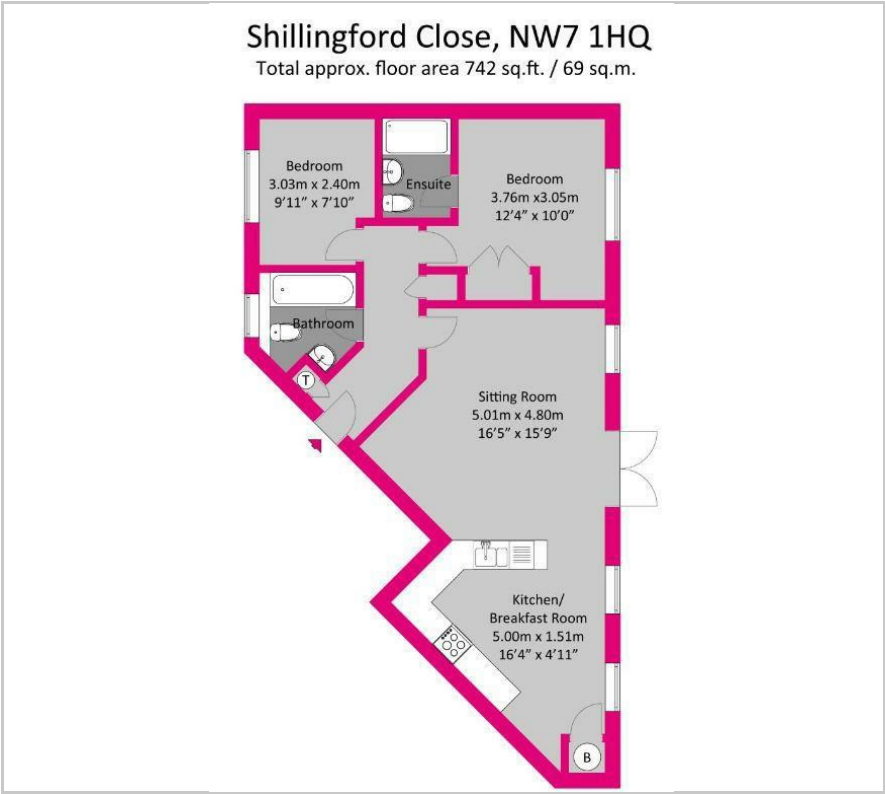

Area Map



Energy Efficiency Graph

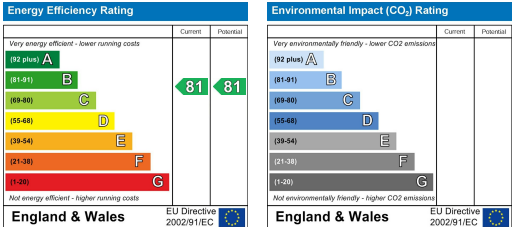

These particulars, whilst believed to be accurate are set out as a general outline only for guidance and do not constitute any part of an offer or contract. Intending purchasers should not rely on them as statements of representation of fact, but must satisfy themselves by inspection or otherwise as to their accuracy. No person in this firms employment has the authority to make or give any representation or warranty in respect of the property.